

▶▶ S102系列滤波器



CE

特征

- ◆ 体积小、性价比高
- ◆ 较高的共模和差模抑制功能
- ◆ 适用于一般电磁防护现场

典型应用

- ◆ 家用电器
- ◆ 实验仪器仪表
- ◆ 计算机及其周边
- ◆ 通讯设备

技术参数

额定电压	250VAC
工作频率	50/60Hz
线-线耐压	1500VDC
线-地耐压	2000VAC
绝缘电阻	>100MΩ @500VDC
工作温升	<30°C@40°C
气候类别 (IEC 60068-1)	25/085/21

选型列表

产品型号	额定电流 (A)	泄漏电流 (mA) @250VAC	外壳	连接端子		电路原理图
				通用	可选	
DTS102-1-W20-A45	1	<0.5	A45		—	
DTS102-3-W20-A45	3	<0.5	A45		—	
DTS102-6-W20-B15	6	<0.5	B15		—	
DTS102-10-F8-D15	10	<0.5	D15		—	
DTS102-20-F8-D15	20	<0.5	D15		—	
DTS102-30-M6-D25	30	<0.5	D25		—	
DTS102-50-M6-D35	50	<0.5	D35		—	

插入损耗

—— 共模 - - - - - 差模 (50 Ω / 50 Ω 测量系统 符合 IEC / CISPR NO. 17)

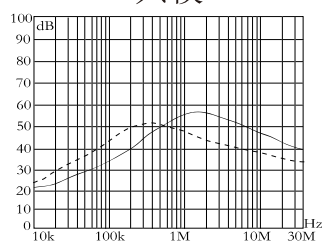

DTS102-1-W20-A45

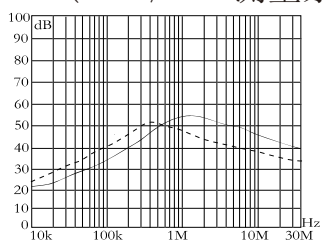

DTS102-3-W20-A45

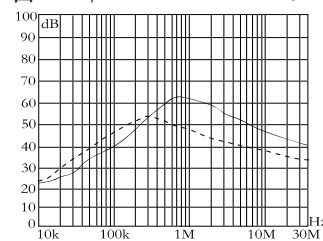

DTS102-6-W20-B15

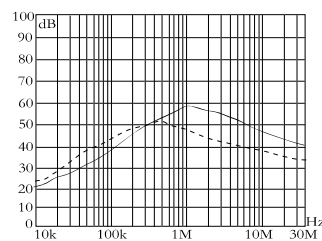

DTS102-10-F8-D15

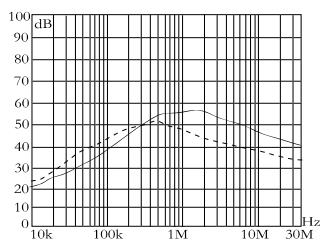

DTS101-20-F8-D15

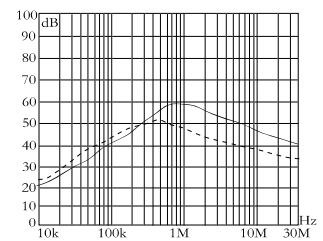

DTS101-30-M6-D25

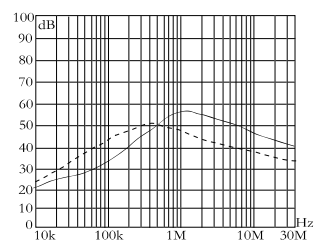

DTS101-50-M6-D35

外形尺寸(mm)

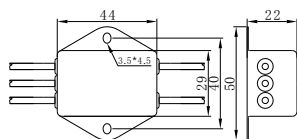

A45 (W20)

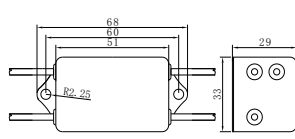

B15 (W20)

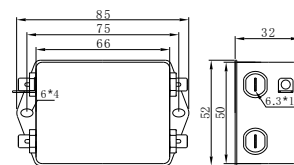

D15 (F8)

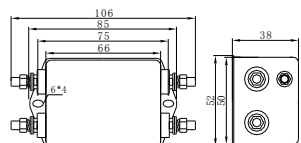

D25 (M6)

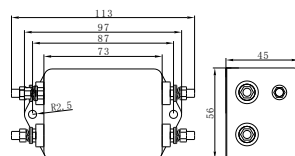

D35 (M6)